



● Portautensili ad albero cavo HSK, DIN 69893 per cambio manuale

▲ Hollow shaft toolholder HSK, DIN 69893, for manual tool change

■ Mandrinos de cono hueco HSK, DIN 69893, para cambio manual

HSK 50 - HSK 63

● Adatti per: ▲ Used with: ■ Válido para:	● Tipo ▲ Type ■ Tipo	● Cod. ord. ▲ Order No. ■ Código	● Dimensioni di montaggio ▲ Assembly dimensions ■ Dimensiones para montaje	● Descrizione ▲ Description ■ Descripción
BEM 20/BEX 15	HSK 50/DP 6	59 545 01	DP 6 L=60 Ø26	<p>● Mandrino di serraggio idraulico ad espansione per tolleranza utensile h6 a Ø 6 e 8 mm, h7 a Ø 10-20 mm</p> <p>▲ Hydraulic expansion chuck, for tool tolerance h6 Ø 6 and 8 mm, h7 Ø 10 to 20 mm</p> <p>■ Mandrino espansivo hidráulico para tolerancia h6 en Ø 6 y 8 mm, h7 en Ø 10 hasta 20 mm</p>
BEM 20/BEX 15	HSK 50/DP 8	59 545 02	DP 8 L=60 Ø28	
BEM 20/BEX 15	HSK 50/DP 10	59 545 03	DP 10 L=65 Ø30	
BEM 20/BEX 15	HSK 50/DP 12	59 545 04	DP 12 L=75 Ø32	
BEM 20/BEX 15	HSK 50/DP 16	59 545 05	DP 16 L=80 Ø38	
BEM 20/BEX 15	HSK 50/DP 20	59 545 06	DP 20 L=80 Ø42	
BEX 35	HSK 63/DP 6	59 545 11	CM 6 L=60 Ø26	<p>● Mandrino di serraggio Weldon DIN 6359</p> <p>▲ End mill adapter, Weldon DIN 6359</p> <p>■ Mandrino Weldon DIN 6359</p>
BEX 35	HSK 63/DP 8	59 545 12	DP 8 L=60 Ø28	
BEX 35	HSK 63/DP 10	59 545 13	DP 10 L=65 Ø30	
BEX 35	HSK 63/DP 12	59 545 14	DP 12 L=75 Ø32	
BEX 35	HSK 63/DP 16	59 545 15	DP 16 L=80 Ø38	
BEX 35	HSK 63/DP 20	59 545 16	DP 20 L=80 Ø42	
BEM 20/BEX 15	HSK 50/W 6	59 545 21	W 6 L=65 Ø25	
BEM 20/BEX 15	HSK 50/W 8	59 545 22	W 8 L=65 Ø28	
BEM 20/BEX 15	HSK 50/W 10	59 545 23	W 10 L=65 Ø35	
BEM 20/BEX 15	HSK 50/W 12	59 545 24	W 12 L=80 Ø42	
BEM 20/BEX 15	HSK 50/W 14	59 545 25	W 14 L=80 Ø44	
BEM 20/BEX 15	HSK 50/W 16	59 545 26	W 16 L=80 Ø48	
BEM 20/BEX 15	HSK 50/W 18	59 545 27	W 18 L=80 Ø50	
BEM 20/BEX 15	HSK 50/W 20	59 545 28	W 20 L=80 Ø52	
BEX 35	HSK 63/W 6	59 545 31	W 6 L=65 Ø25	
BEX 35	HSK 63/W 8	59 545 32	W 8 L=65 Ø28	
BEX 35	HSK 63/W 10	59 545 33	W 10 L=65 Ø35	
BEX 35	HSK 63/W 12	59 545 34	W 12 L=80 Ø42	
BEX 35	HSK 63/W 14	59 545 35	W 14 L=80 Ø44	
BEX 35	HSK 63/W 16	59 545 36	W 16 L=80 Ø48	
BEX 35	HSK 63/W 18	59 545 37	W 18 L=80 Ø50	
BEX 35	HSK 63/W 20	59 545 38	W 20 L=80 Ø52	
BEX 35	HSK 63/W 25	59 545 39	W 25 L=110 Ø65	
BEX 35	HSK 63/W 32	59 545 40	W 32 L=110 Ø72	
BEM 20/BEX 15	HSK 50/ER 16	59 545 51	ER 16 L=100 Ø28	<p>● Portautensili per pinza ER, pagina G 03</p> <p>▲ Collet chuck for collet ER, page G 03</p> <p>■ Portapinzas ER, página G 03</p>
BEM 20/BEX 15	HSK 50/ER 32	59 545 52	ER 32 L=100 Ø50	
BEX 35	HSK 63/ER 16	59 545 53	ER 16 L=100 Ø28	
BEX 35	HSK 63/ER 32	59 545 54	ER 32 L=100 Ø50	

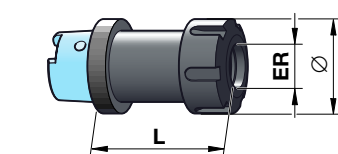
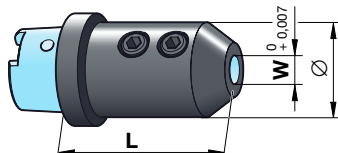
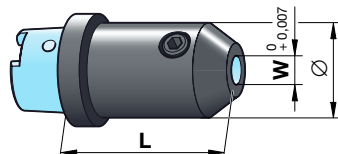
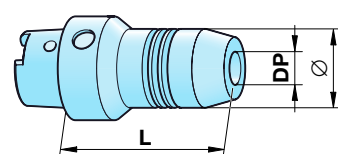

● Adatti per: ▲ Used with: ■ Válido para:	● Tipo ▲ Type ■ Tipo	● Cod. ord. ▲ Order No. ■ Código	● Dimensioni di montaggio ▲ Assembly dimensions ■ Dimensiones para montaje	● Descrizione ▲ Description ■ Descripción
BEM 20/BEX 15	HSK 50/WT 8	59 546 01	WT 0,5-8 L=78 Ø36	<p>● Mandrino idraulico fino a 35.000 min⁻¹, 30, 80, 90 Nm</p> <p>▲ NC drill chucks, up to 35 000 RPM, 30, 80, 90 Nm</p> <p>■ Portabrocas CNC universal, hasta 35 000 rpm, 30, 80, 90 Nm</p>
BEM 20/BEX 15	HSK 50/WT 9	59 546 02	WT 1-13 L=116 Ø50	
BEX 35	HSK 63/WT 10	59 546 03	WT 0,5-8 L=80 Ø36	
BEX 35	HSK 63/WT 11	59 546 04	WT 1-13 L=104 Ø50	
BEX 35	HSK 63/WT 12	59 546 05	WT 3-16 L=104 Ø57	<p>● Mandrino a cambio rapido per maschiatura, pressione, trazione</p> <p>▲ Quick-change spindle adapter. Tension and compression</p> <p>■ Mandrino de rosca de cambio rápido, a compresión, tracción</p>
BEM 20/BEX 15	HSK 50/WE 2	59 546 11	WE 2 L=72 Ø36	
BEM 20/BEX 15	HSK 50/WE 3	59 546 12	WE 3 L=110 Ø53	
BEX 35	HSK 63/WE 2	59 546 13	WE 2 L=72 Ø36	
BEX 35	HSK 63/WE 3	59 546 14	WE 3 L=110 Ø53	<p>● Mandrini portafresa a manico combinati per frese con scanalatura longitudinale e trasversale</p> <p>▲ Combination face mill adapter for cutters with transversal slot or key drive</p> <p>■ Mandrino para fresas con chavetero longitudinal y transversal</p>
BEX 35	HSK 63/WE 4	59 546 15	WE 4 L=141 Ø78	
BEM 20/BEX 15	HSK 50/FD 16	59 546 21	Ø16 L=40 l=27	
BEM 20/BEX 15	HSK 50/FD 22	59 546 22	Ø22 L=38 l=31	
BEM 20/BEX 15	HSK 50/FD 27	59 546 23	Ø27 L=53 l=33	<p>● Ghiera di serraggio</p> <p>▲ Ring driver</p> <p>■ Anillo de arrastre</p>
BEM 20/BEX 15	HSK 50/FD 32	59 546 24	Ø32 L=51 l=38	
BEX 35	HSK 63/FD 16	59 546 25	Ø16 L=40 l=27	
BEX 35	HSK 63/FD 22	59 546 26	Ø22 L=38 l=31	
BEX 35	HSK 63/FD 27	59 546 27	Ø27 L=53 l=33	<p>● Bussole di adattamento con cono Morse con chavetta di trascinamento DIN 228B</p> <p>▲ Morse taper adapters and flat tang DIN 228B</p> <p>■ Mandrino con cono morse y arrastre DIN 228B</p>
BEX 35	HSK 63/FD 32	59 546 28	Ø32 L=51 l=38	
BEX 35	HSK 63/FD 40	59 546 29	Ø40 L=56 l=41	
BEM 20/BEX 15	HSK 50/MK 1	59 546 31	CM 1 L=100 Ø25	
BEM 20/BEX 15	HSK 50/MK 2	59 546 32	CM 2 L=120 Ø32	<p>● Getti grezzi per la produzione di utensili speciali</p> <p>▲ Spindle adapter blanks for special purpose tooling</p> <p>■ Pieza en bruto para fabricar herramientas especiales</p>
BEM 20/BEX 15	HSK 50/MK 3	59 546 33	CM 3 L=140 Ø40	
BEX 35	HSK 63/MK 1	59 546 34	CM 1 L=100 Ø25	
BEX 35	HSK 63/MK 2	59 546 35	CM 2 L=120 Ø32	
BEX 35	HSK 63/MK 3	59 546 36	CM 3 L=140 Ø40	<p>● Alesatore con placchetta non riaffabile: su richiesta</p> <p>▲ Boring bar with carbide inserts upon request</p> <p>■ Mandrino de taladrar con plaquetas: bajo demanda</p>
BEX 35	HSK 63/MK 4	59 546 37	CM 4 L=160 Ø48	
BEM 20/BEX 15	HSK 50/RG 1	59 546 41	HSK 50 L=200 Ø63	
BEX 35	HSK 63/RG 1	59 546 42	HSK 63 L=200 Ø80	
BEM 20/BEX 15	HSK 50/KU 44	—	Ø12-44 max. L=138 max. l=88	<p>● Attacchi ABS per portautensili pagina G 14</p> <p>▲ ABS adapters for end mill adapter page G 14</p> <p>■ Mandrino ABS para portaherramientas de pag. G 14</p>
BEM 20/BEX 15	HSK 50/A 25	59 546 51	ABS 25 L=50 Ø13	
BEM 20/BEX 15	HSK 50/A 32	59 546 52	ABS 32 L=50 Ø16	
BEM 20/BEX 15	HSK 50/A 40	59 546 53	ABS 40 L=60 Ø20	
BEM 20/BEX 15	HSK 50/A 50	59 546 54	ABS 50 L=70 Ø28	<p>● Attacchi ABS per portautensili pagina G 14</p> <p>▲ ABS adapters for end mill adapter page G 14</p> <p>■ Mandrino ABS para portaherramientas de pag. G 14</p>
BEX 35	HSK 63/A 25	59 546 55	ABS 25 L=50 Ø13	
BEX 35	HSK 63/A 32	59 546 56	ABS 32 L=50 Ø16	
BEX 35	HSK 63/A 40	59 546 57	ABS 40 L=60 Ø20	
BEX 35	HSK 63/A 50	59 546 58	ABS 50 L=70 Ø28	
BEX 35	HSK 63/A 63	59 546 59	ABS 63 L=80 Ø34	
BEX 35	HSK 63/A 80	59 546 60	ABS 80 L=80 Ø46	

